

Chapter 10

ABOUT SCC

2011-2012 Board of Governors

		
Lynn Schluckebier Chair, District 1 215 East Jackson Avenue, Seward, NE 68434	Robert J. Feit Vice Chair, District 3 PO Box 106, Pickrell, NE 68422	James J. Garver Secretary, At-Large 815 Elmwood Ave., Lincoln, NE 68510
		
Kathy Boellstorff Treasurer, District 2 62902 - 733rd Road, Johnson, NE 68378	Helen Griffin District 5 901 S 51st Street, Lincoln, NE 68510	Ed C. Heiden District 2 RR 1, Box 117, Sterling, NE 68443
		
Carl Humphrey District 1 10311 N. 150th Street, Waverly, NE 68462	Ruth M. Johnson District 4 819 North 33rd Street, Lincoln, NE 68503	Dale Kruse District 3 1200 S. Fifth Avenue, Beatrice, NE 68310
		
Terrence L. Kubicek District 5 1800 S. 53 Street, Lincoln, NE 68506	Nancy A. Seim District 4 2515 North 76th Street, Lincoln, NE 68507	Steve Ottmann, Faculty Representative SCC Lincoln Campus, Lincoln, NE 68520

The SCC Mission...

Southeast Community College values the opportunity to provide quality applied technology and academic educational opportunities for the students, businesses and communities of our district. To achieve that purpose, SCC will:

- Continue to value local governance
- Value and support diversity
- Be affordable and accessible
- Develop and maintain partnerships
- Provide responsive delivery systems
- Respond to emerging technology
- Promote continuous improvement
- Promote student learning through the provision of quality instruction, curriculum and appropriate facilities
- Embrace lifelong learning
- Maximize and utilize resources efficiently
- Be accountable
- Encourage a positive environment
- Promote recruitment and retention
- Be communicative
- Be fiscally responsible

Nondiscrimination Policy

Equal Opportunity/Nondiscrimination Policy - It is the policy of Southeast Community College to provide equal opportunity and nondiscrimination in all admission, attendance, and employment matters to all persons without regard to race, color, religion, sex, age, marital status, national origin, ancestry, veteran status, sexual orientation, disability, or other factors prohibited by law or College policy. Inquiries concerning the application of Southeast Community College's policies on equal opportunity and nondiscrimination should be directed to the Vice President for Access/Equity/Diversity, SCC Area Office, 301 S. 68th Street Place, Lincoln, NE 68510, 402-323-3412, FAX 402-323-3420, or jsoto@southeast.edu.

Declaración de política sobre equidad/antidiscriminación - La política pública de Southeast Community College es de proveer equidad, y prohíbe discriminación, en todos asuntos referentes a la admisión, participación, y empleo contra toda persona por motivo de raza, color, religión, sexo, edad, estado civil, origen nacional, ascendencia, condición de veterano, orientación sexual, incapacidad, u otros factores prohibidos por ley o política del Colegio. Preguntas relacionadas a la política sobre equidad/antidiscriminación de Southeast Community College deben dirigirse a: Vice President for Access/Equity/Diversity, SCC Area Office, 301 S 68 Street Place, Lincoln, NE 68510, 402-323-3412, FAX 402-323-3420, o jsoto@southeast.edu.

College Administration

Dr. Jack J. Huck, President

Dr. Dennis Headrick, Vice President for Instruction

Bob Morgan/Dean of Virtual Learning/Beatrice Campus Director

Lyle Neal, Vice President for Technology/Milford Campus Director

Ted Suhr, Vice President for Administrative Services/Resource Development

José Soto, Vice President for Access/Equity/Diversity

Jeanette Volker, Vice President for Student Services/Lincoln Campus Director

Limitations of Catalog Information

This publication should not be considered a contract between SCC and any prospective student. SCC's Board of Governors reserves the right to make changes in this publication during the life of the publication and without notice.

ABOUT SCC



SCC is a two-year institution of higher education governed by an 11 member Board of Governors. The College's primary service area is comprised of 15 counties. The college operates on the quarter system and has campuses in Beatrice, Lincoln and Milford. SCC offers more than 50 Programs of Study, most technical in nature. Job placement is what makes SCC such a good choice. More than 90 percent of graduates continue to find employment or continue their education.

Accreditation

SCC is fully accredited by the Higher Learning Commission, a commission of the North Central Association of Colleges and Schools.

Higher Learning Commission

230 S. LaSalle St., Suite 7-500, Chicago, IL 60604
 800-621-7440 | (312) 263-0456 | Fax: (312) 263-7462
 E-mail: info@hlcommission.org | Web site: www.ncahlc.org

Awards

SCC awards the following to students who successfully complete a required program of study:

- Associate of Applied Science Degree
- Associate of Arts Degree
- Associate of Occupational Studies Degree
- Associate of Science Degree
- Certificate
- Diploma

Calendar

SCC operates on a quarter calendar system with terms that start in January (Winter), March (Spring), July (Summer) and October (Fall).

Enrollment

The 2010 Fall Quarter enrollment was 11,914 students, the largest in school history. During the 2009-10 academic year, the College also served more than 17,300 non-credit students enrolled in Continuing Education classes on the campuses and in communities throughout southeast Nebraska.

Entrepreneurship Center

Located at 285 S. 68th St. Place in Lincoln, SCC's Entrepreneurship Center serves as a resource center for anyone interested in entrepreneurship. The center staff offers assistance to anyone interested in starting a business or looking for direction on their path to business independence. One floor of the center is dedicated to business incubation. The center also hosts credit and non-credit classes on entrepreneurship and is home to Lincoln Public School's Entrepreneurship Focus Program and the Information Technology Program.



History

The College has been operating in its current structure since July 1, 1973, when a statewide community college system was implemented by the Legislature. However, the campus in Milford existed long before 1973. The first postsecondary technical institution, exclusively offering two-year postsecondary degrees in vocational/technical programs, was established by the Nebraska Unicameral in 1941 at Milford. Operated by the Nebraska Department of Education, the school was originally established to meet the occupational education needs of the entire state. In 1971, the Legislature passed a bill which combined junior colleges (Fairbury, established in 1941, in SCC's area), state vocational/technical colleges,

and the area technical schools into one system of two-year institutions. The consolidation originally established eight technical community college areas. The number was reduced to six when Lincoln merged with Southeast in 1973. As conceived in 1971, Nebraska community college areas were to be governed locally by elected boards. Southeast derives its operating revenue from three major sources: local property taxes, state aid (a combination of sales and income tax funds apportioned by the Legislature), and tuition.

Locations

The College operates primary campuses in Beatrice, Lincoln and Milford, as well as more than 20 off-campus sites within the 15 counties.

Beatrice Campus

4771 W. Scott Road, Beatrice, NE 68310-7042
 800-233-5027, (402) 228-3468, Fax: (402) 228-2218

Lincoln Campus

8800 O St., Lincoln, NE 68520-1299
 800-642-4075, (402) 471-3333, Fax: (402) 437-2404

Milford Campus

600 State St., Milford, NE 68405-8498
 800-933-7223, (402) 761-2131, Fax: (402) 761-2324

Area Office

301 S. 68th St. Place, Lincoln, NE 68510-2449
 (402) 323-3400, Fax: (402) 323-3420

Continuing Education Center

301 S. 68th St. Place, Lincoln, NE 68510-2449
 800-828-0072, (402) 437-2700, Fax: (402) 437-2703

Energy Square

1111 O St., Suite 112, Lincoln, NE 68508-3614
 (402) 323-3441, Fax: (402) 323-3453

Entrepreneurship Center

285 S. 68th St. Place, Lincoln, NE 68510-2449
 (402) 323-3383, Fax: (402) 323-3399

Primary Service Area

The College serves the following 15 counties in southeast Nebraska:

Cass	Lancaster	Saline
Fillmore	Nemaha	Saunders
Gage	Otoe	Seward
Jefferson	Pawnee	Thayer
Johnson	Richardson	York

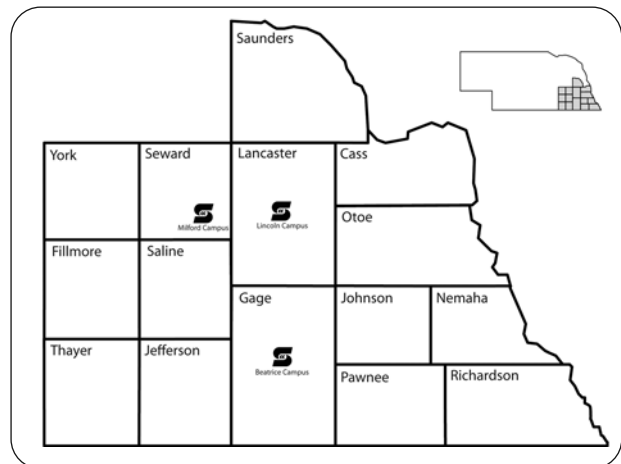

Technical & Career Education

Students may choose from applied technology programs grouped into seven divisions:

- 1) Agriculture/Food/Natural Resources Division
- 2) Business Division
- 3) Communications & Information Technology Division
- 4) Community Services & Resources Division
- 5) Construction & Electronics Division
- 6) Health Sciences Division
- 7) Transportation & Manufacturing Division

Job opportunities in each area are growing as the demands for employees with technical knowledge and skills increase. Business and industry advisory groups provide suggestions on standards, trends, emerging technology and course content.



Academic Transfer Education

SCC offers the first two years of college course work for transfer to four-year colleges and universities within the **Arts & Sciences Division**. Students enrolled in the academic transfer program may earn an Associate of Arts or an Associate of Science Degree. Located within the division are Developmental Education, General Education,

Humanities, Math, Science, and Social Science. Transfer of credits has become easier since the approval of the Nebraska Transfer Initiative in 1995. Students who begin their college careers at SCC, and transfer credits to a four-year college, graduate at rates comparable to those who began their college work at a four-year institution.

Student Activities

Each campus offers students opportunities to build leadership skills and friendships in organizations such as Student Senate and Phi Theta Kappa, the national community college scholastic honor society. Students may also participate in career-specific groups such as the Licensed Practical Nurses Association of Nebraska, and student chapters of such organizations as the Society of Manufacturing Engineers. In addition to career-related and scholastic groups, the Beatrice campus offers the following intercollegiate sports: men's and women's basketball, men's golf and baseball, and women's volleyball and softball. SCC-Beatrice also provides a variety of other activities, including art, theatre, and vocal and instrumental music. Each campus offers intramural sports and wellness centers where students can use exercise equipment and participate in aerobic and fitness activities.



Housing

SCC campuses in Beatrice and Milford offer residence hall living for single students. The Milford Campus also has housing for married couples and single parents. The Lincoln Campus maintains rental listings, city maps, and costs to assist students with their living arrangements.

Placement

In recent years, more than 90 percent of SCC graduates regularly report placement in training-related positions or in continued education following graduation. Most career program graduates receive multiple job offers, many before they graduate. Graduates are entitled to lifetime job placement services. In response to College surveys, employers report high satisfaction with the preparation and work habits of SCC graduates.

Instruction

SCC instructors are highly qualified. Academic instructors have completed master's degrees in their teaching fields. Some instructors have earned doctorates or have completed hours toward their doctoral degrees. Technical instructors have both formal and vocational education.

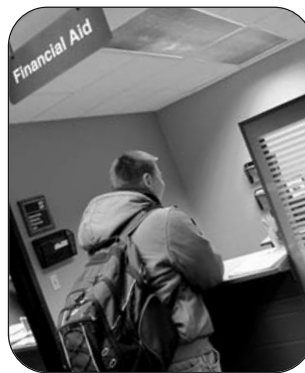

Services

SCC provides students with a wide variety of services, such as academic advising, disability services, financial aid, tutoring, TRIO Student Support Services, and TRIO Upward Bound. Students also have access to cafeterias, ample parking, housing (Beatrice and Milford), and a child development center in Lincoln. The College provides libraries, computer labs with Internet access, and placement services. These services support classroom experiences and help make a college education more accessible to prospective students.

Student Population

Nearly half of the nation's first-time freshmen enroll at community colleges. More and more students take classes simultaneously at two colleges. Flexible schedules, cost, convenient locations and small classrooms make community colleges a good education investment. Nebraska community colleges and four-year institutions work together to make co-enrollment and transfer of credit as easy as possible.

Student Diversity

SCC values diversity and seeks to recruit and retain students from a variety of cultures, races and ethnic groups. The College values the heritage and viewpoint each student brings to the campuses and classrooms. SCC offers activities, services and recognitions celebrating diversity. Support programs are offered for students of a variety of races and cultures as well as single parents and persons who are entering non-traditional careers. SCC also welcomes students with disabilities and complies with the Americans with Disabilities Act. College programs and activities are based on the principle that all students have the right to obtain an education in a college environment free from all forms of discrimination and harassment.



SECC *Southeast* community college



Beatrice Campus

4771 W. Scott Rd.
Beatrice, NE 68310
Fax: 402-228-2218
402-228-3468 | 800-233-5027



Beatrice Campus offers

- Athletics
- Fine Arts
- Housing

and the following programs:

- Academic Transfer
- Agriculture Business & Management Technology
- Business Administration
- Criminal Justice
- Office Professional
- Pharmacy Technician
- Practical Nursing

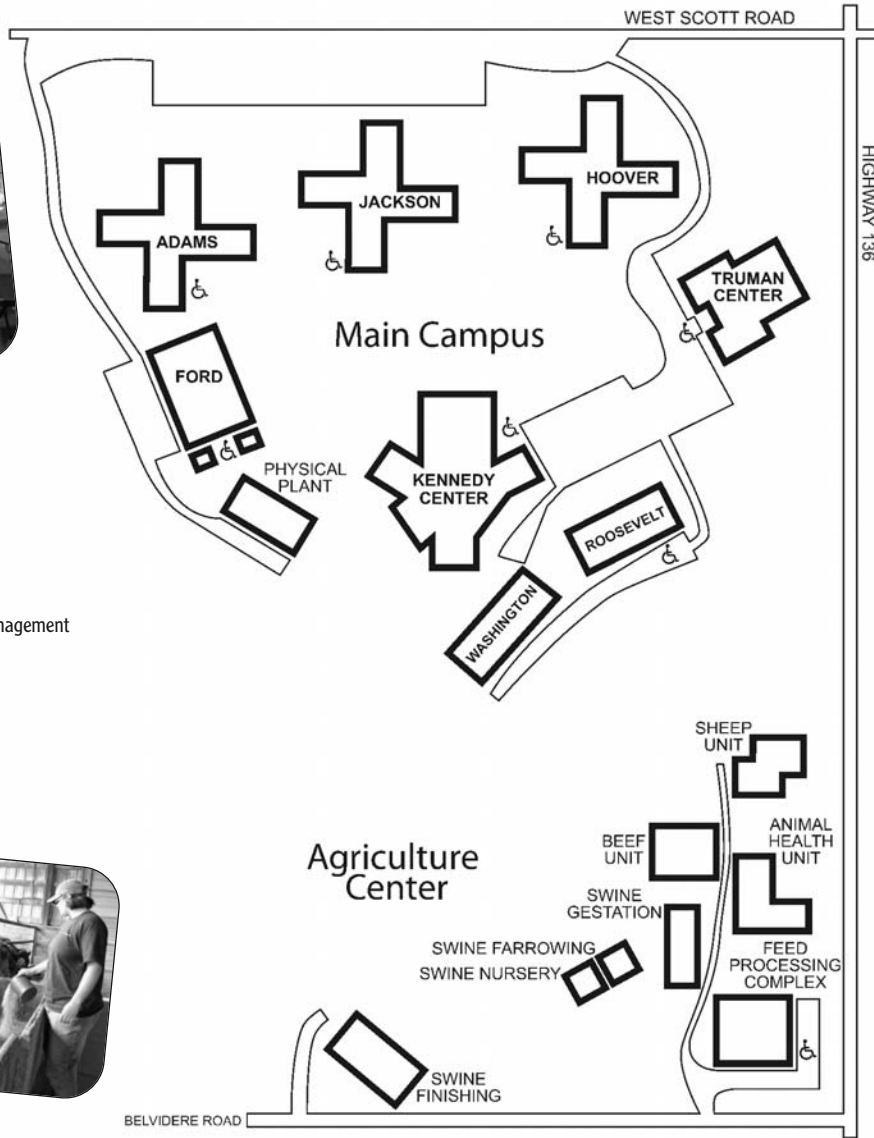

The campus is located on 640 acres on the west edge of Beatrice, Nebraska.

Schedule a visit online or call to schedule a tour.

Adams Hall: One-Stop Community Resource Center

Agriculture Center: The Agriculture Center, a model land and animal laboratory for the Agriculture Business and Management Technology program, is located one mile south of the main campus.

Ford Hall: Classrooms for Ag Equipment, Ag Mechanics, Crops, Golf/Turfgrass, Horticulture and Ag Business

Hoover Hall: Pharmacy Technician, TRIO Student Support Services, TRIO Upward Bound, Residence Hall

Jackson Hall: ABE/GED, Career Advising Center, Retention, Testing & Assessment, Tutoring

Classrooms for: Business Administration, Distance Learning, Journalism, Office Professional, Practical Nursing, Photography.

Kennedy Center: Administration, Admissions, Advising, Athletics, Bookstore, Cashier, Computer Lab, Continuing Education, Financial Aid, Learning Resource Center, Placement, Registration, Student Center, Snack Bar, Student Services

Classrooms for: Languages, Life Sciences, Math/Physics, Social Sciences

Truman Center: Gymnasium, Theatre, Wellness Center.

Classrooms for: Art, Theatre, Speech, Music

Carter Building: Student housing located off-campus for qualified students with families.

Roosevelt Hall: Residence Hall

Washington Hall: Residence Hall

SE Southeast community college



Milford Campus

600 State St.
Milford, NE 68405
Fax: 402-761-2324
402-761-2131 | 800-933-7223

ETC has classrooms for:

- Architectural-Engineering Technology
- Auto Collision Repair Technology
- Automotive Technology
- Building Construction Technology
- Business Administration
- Computer Programming Technology
- Chrysler (CAP)
- Diesel Ag Equipment Service Tech
- Diesel Technology-Truck
- Electrical & Electromechanical Technology
- Electronic Systems Technology
- Energy Generation Operations
- Ford (ASSET)
- General Motors (ASEP)
- Graphic Design
- Land Surveying/Civil Engineering Technology
- Machine Tool Technology
- Manufacturing Engineering Technology
- Nondestructive Testing Technology
- Parts Marketing & Management
- Welding Technology

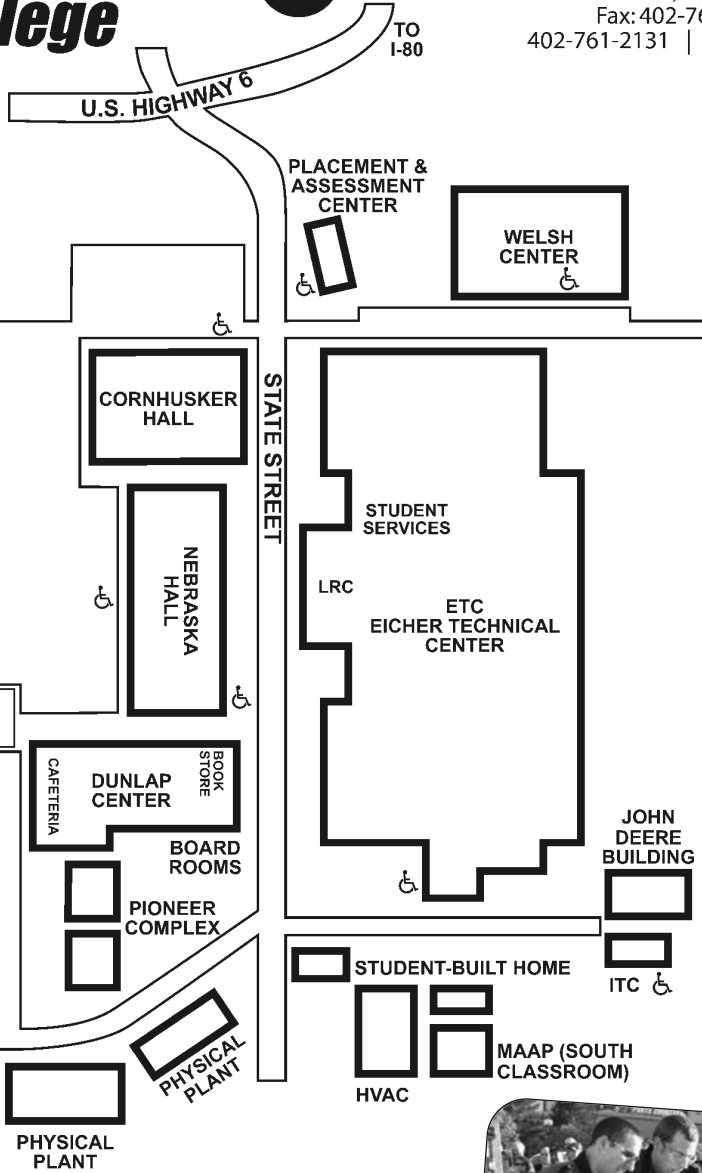

The campus is located on 53.5 acres in Milford, Nebraska.

Schedule a visit online or call to schedule a tour.

ETC-Eicher Technical Center: Admissions, Business Office, Cashier, Computer Lab, Campus Administration, Financial Aid, Learning Resource Center, Registration, Retention, Student Lounge, Student Services, TRIO Student Support Services. Classrooms for many programs.



(G. Alan) Dunlap Center: Cafeteria, Bookstore, Conference Rooms

HVAC: Classrooms for: Heating, Ventilation, Air Conditioning, and Refrigeration Technology

ITC: Industry Training Center

John Deere Building: Classrooms for: Deere Construction and Forestry Equipment Tech; John Deere Tech

Lowell A. Welsh Center: Legacy Room, Gymnasium, Heritage Room, Student Center

MAAP (South Classroom): Classrooms for: Major Appliance Professional Technology

Placement & Assessment Center: Assessment/Testing, Career Advising, Placement

Cornhusker Hall: Residence Hall

Nebraska Hall: Residence Hall

Pioneer Complex: Residence Halls

Established in 1941,
SCC-Milford enjoys a long history
as Nebraska's premier technical college.

Southwest community college



Lincoln Campus

8800 "O" Street
Lincoln, NE 68520
Fax: 402-437-2404
402-471-3333 | 800-642-4075

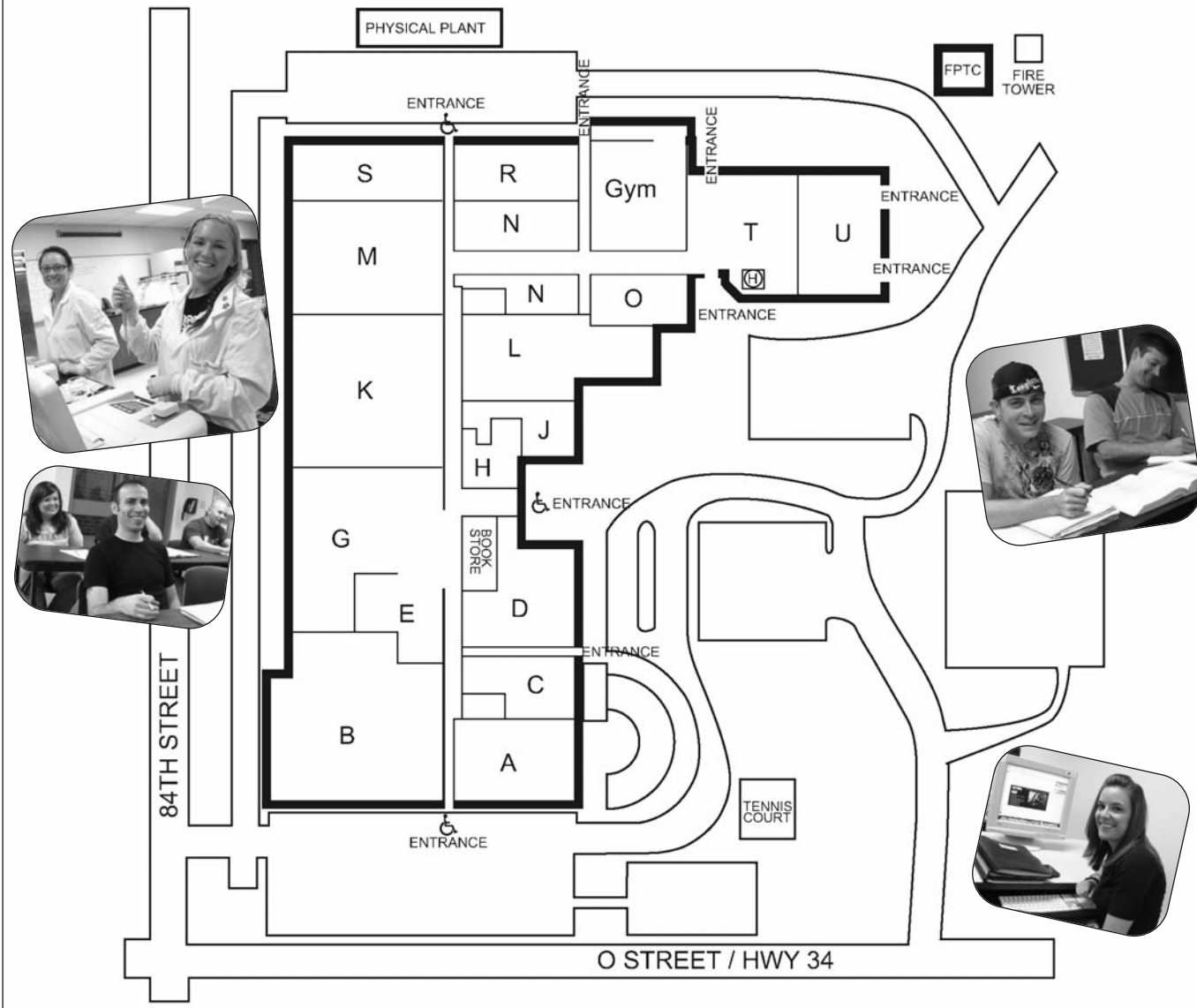

The Lincoln Campus is located on the east edge of the capital city and houses a 320,000 square-foot facility on 117 acres. Schedule a visit online or call to schedule a tour of the Lincoln Campus and downtown Energy Square location.

- A Classrooms for: Laboratory Science, General Studies
- B Classrooms for: Associate Degree Nursing, Dental Assisting, Emergency Medical Services/Paramedic, Health Information Management Systems, Medical Assisting, Medical Laboratory Technology, Physical Therapist Assistant, Polysomnographic Technician, Practical Nursing, Radiologic Technology, Respiratory Care, Surgical Technology
- C Child Development Center
- D Bookstore
Classrooms for: Associate Degree Nursing, Early Childhood Education

- E Admissions, Cashier, Financial Aid, Registration and Records, Student Services;
Classrooms for: Food Service/Hospitality
- F Campus Administration
- FPTC: Fire Protection Training Center
Classrooms for: Fire Protection Technology
- G Cafeteria, Shipping/Receiving;
Classrooms for: Food Service/Hospitality
- H Placement Office, Retention Office, TRIO Student Support Services
- J Continuing Education, Career Advising Center
- K Classrooms for: Machine Tool Technology; Motorcycle, ATV, & Personal Watercraft Technology; Welding Technology
- L Learning Resource Center including ABE/GED, Advising, Assessment & Testing, Computer Lab, Media Production, Multi-Academic Center (Tutoring)

- M Classrooms for: Automotive Technology
- N Classrooms for: Computer Aided Design Drafting; Electronic Systems Technology
- O Student Activities Center, Gym, Student Center, Wellness Center
- R Classrooms for: Computer Information Technology
- S Classrooms for: Professional Truck Driver Training
- T Classrooms for: Business Administration, Office Professional
- U Academic Advising; Multi-Purpose Room
Classrooms for: Academic Transfer Education, Continuing Education, Human Services, Visual Publications,

Southwest community college



Energy Square

(downtown location)
 1111 "O" Street, Suite 112
 Lincoln, NE 68508
 Fax: 402-323-3453
 402-323-3441 | 800-642-4075

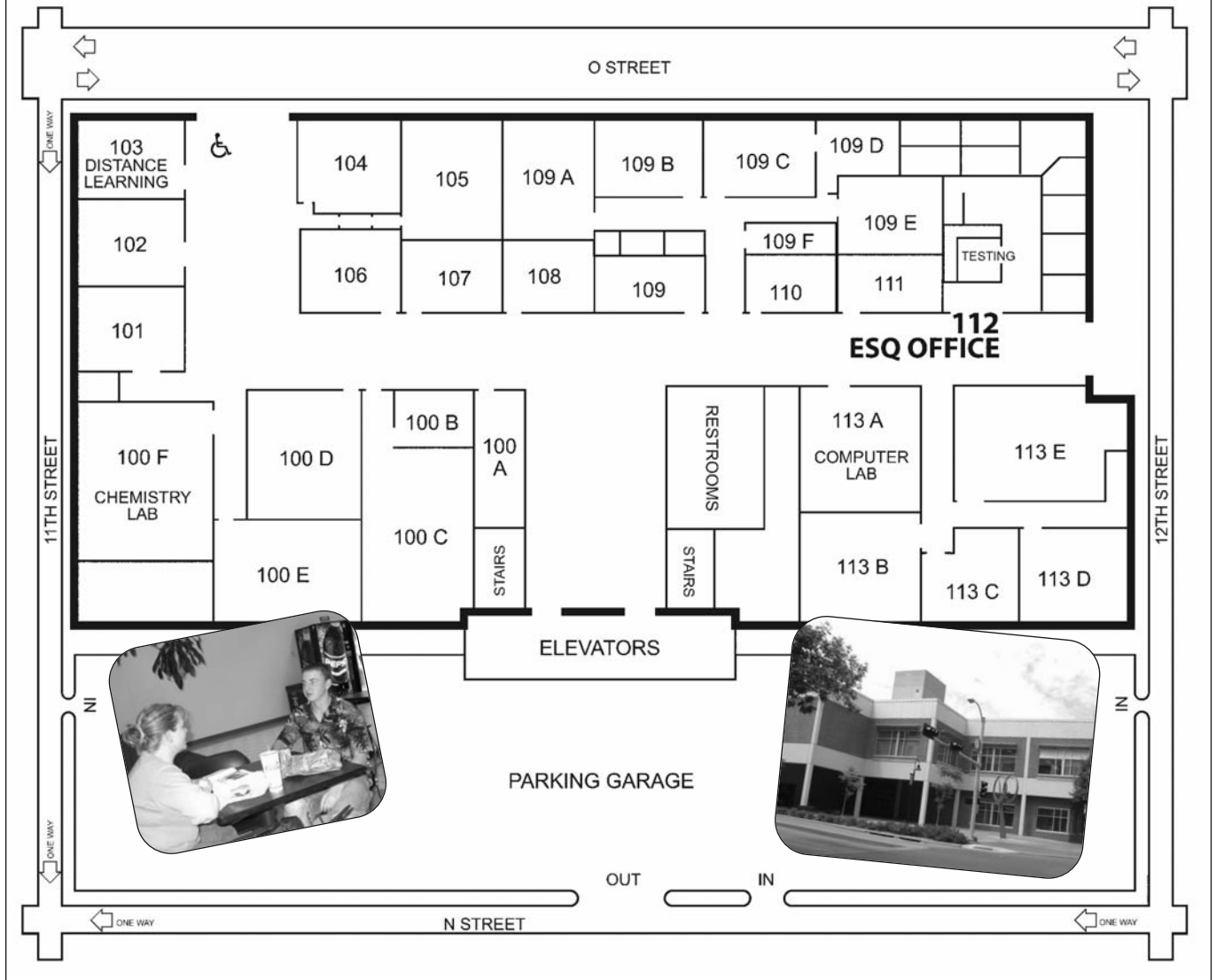

The ESQ location offers convenience in downtown Lincoln, at 1111 O Street, on the first floor of the Energy Square Building.

The downtown location offers Academic Transfer classes.

Suite 112: Offices for Academic Transfer;
 Criminal Justice; General Information

Classrooms for:

Room 100F: Chemistry Laboratory

Room 103: Distance Learning

Room 104: ABE/GED

Rooms 100C, 100D, 100E, 101, 102, 104-111, 113A, 113B, 113E: General Classrooms

Room 113C & 113D: Training Solutions for Business & Industry

Discount parking is available through the

CITY OF LINCOLN PARKING OFFICE

850 "Q" Street, 402-441-PARK,

7:30 am-5:30 pm.

You must bring your student ID and CURRENT TERM class schedule.



NCEE: (Located off-campus)

Nebraska Center for Excellence in Electronics

4740 Discovery Drive, Lincoln NE

Classrooms for: Customized Training Services for Business and Industry

South east community college



Continuing Education Center

301 S. 68th Street Place
Lincoln, NE 68510
Fax: 402-437-2703
402-437-2700 | 800-828-0072

Entrepreneurship Center

285 S. 68th Street Place
Lincoln, NE 68510
Fax: 402-323-3399
402-323-3383 | 800-642-4075



CEC/ENT 1st Floor



The Entrepreneurship Center is used for nursing, business-related offerings and entrepreneur incubator businesses.

SCC's Entrepreneurship Center staff and services can help guide students and community members toward education which is physical, virtual and practical in nature.

It is a place to go to have questions answered by professionals regarding starting or maintaining an entrepreneurial venture.

ENT 1st floor: (west side entrance at street level)

ENT105: Office for Continuing Education's Emergency Medical Services Paramedic, Part I & Part II classes.

ENT106: Office for Continuing Education's CPR and First Aid

ENT107: Office for Continuing Education's Nursing Assistant & Medication Aide

ENT109B: Classroom and Office for adjunct instructors for Continuing Education Nursing Assistant

Classrooms for: Continuing Education Nursing Assistant, Medication Aide

Access between CEC and ENTR buildings is allowed through double doors.

The Continuing Education Center is used for a variety of purposes, including special classes and seminars in personal development and Professional Development Customized Training programs for business and industry.

The Center offers some of the most sophisticated technological capabilities in Lincoln, including state-of-the-art equipment allowing communication throughout the world.

The College Food Service/Hospitality program uses the first floor of the Center as a satellite training laboratory.

The College Administration (SCC-Area Office) is located on the fifth floor of the building.

CEC 1st floor: (Basement Level) Kitchen

Classrooms for: Continuing Education and Food Service/Hospitality

ENT 2nd floor: (main entrance at Street Level)

Commons Area, Reception Desk, Vending Machines

Classrooms and Computer Lab

Offices for: Entrepreneurship Center; Legal; and Continuing Education Accounting, Business Resources, Training Solutions

Access between CEC and ENTR buildings is allowed through double doors.

CEC 2nd floor: (Street Level)

Auditorium, Commons Area, Reception Desk, Vending Machines

Offices for: Continuing Education Directors of Training Solutions for Business & Industry, Multi-Media Education Services/eLearning Design



2nd floor

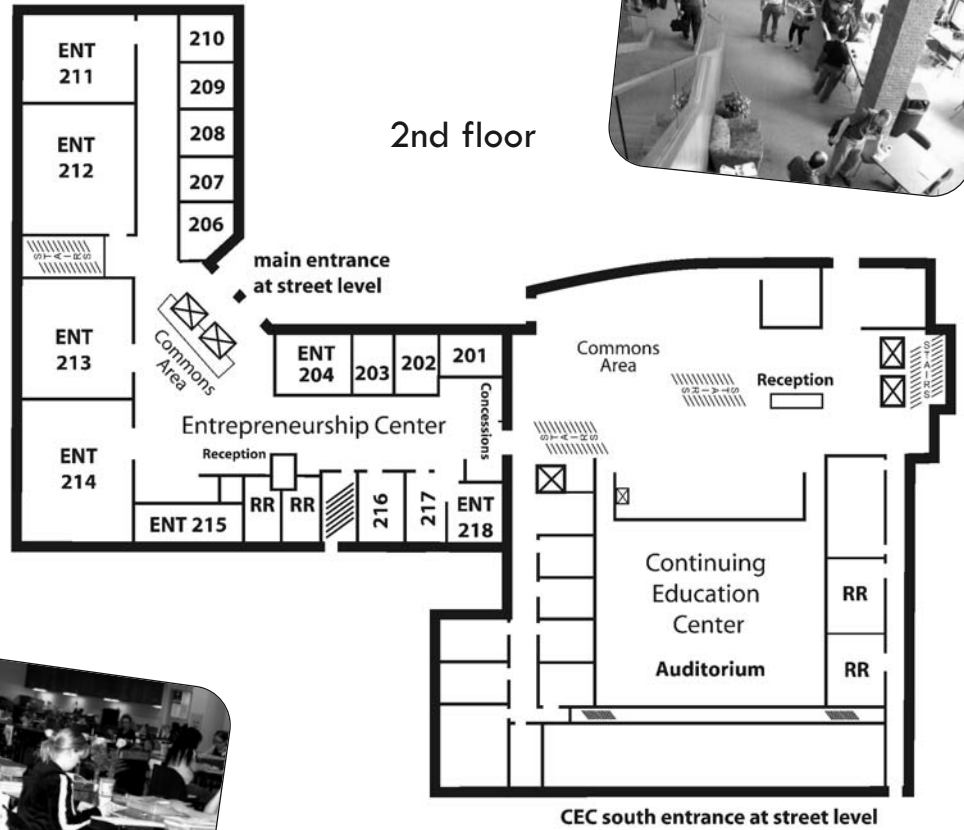

3rd floor

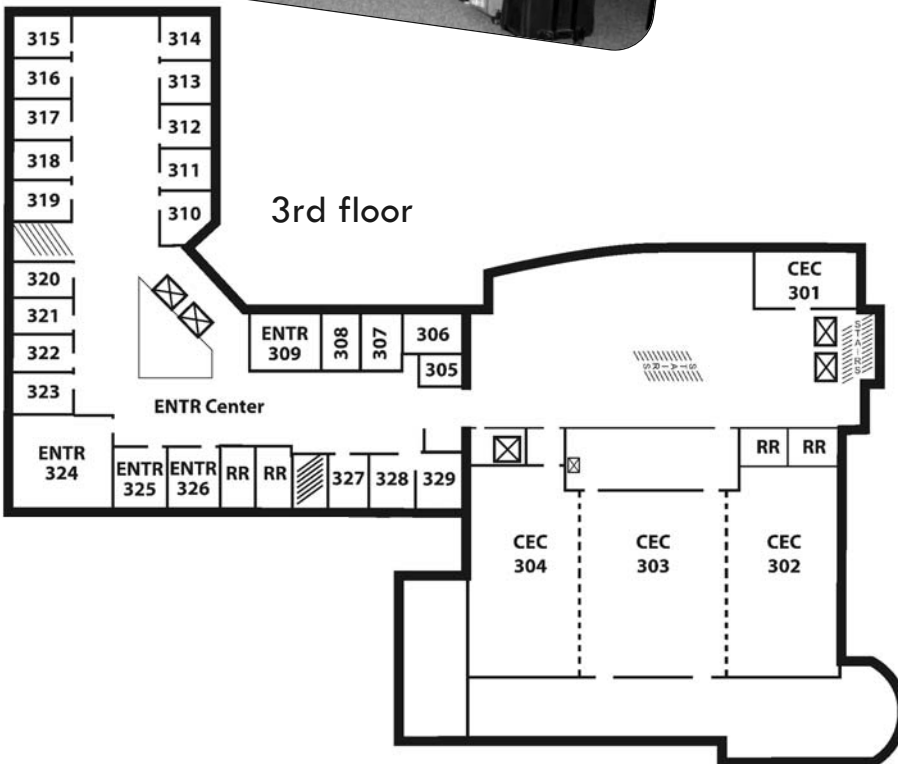

ENT 3rd floor:

Classrooms
Entrepreneurship Incubator Businesses

Access between CEC and ENTR buildings is allowed through double doors.

CEC 3rd floor: Classrooms for Workshops, Seminars and Conferences

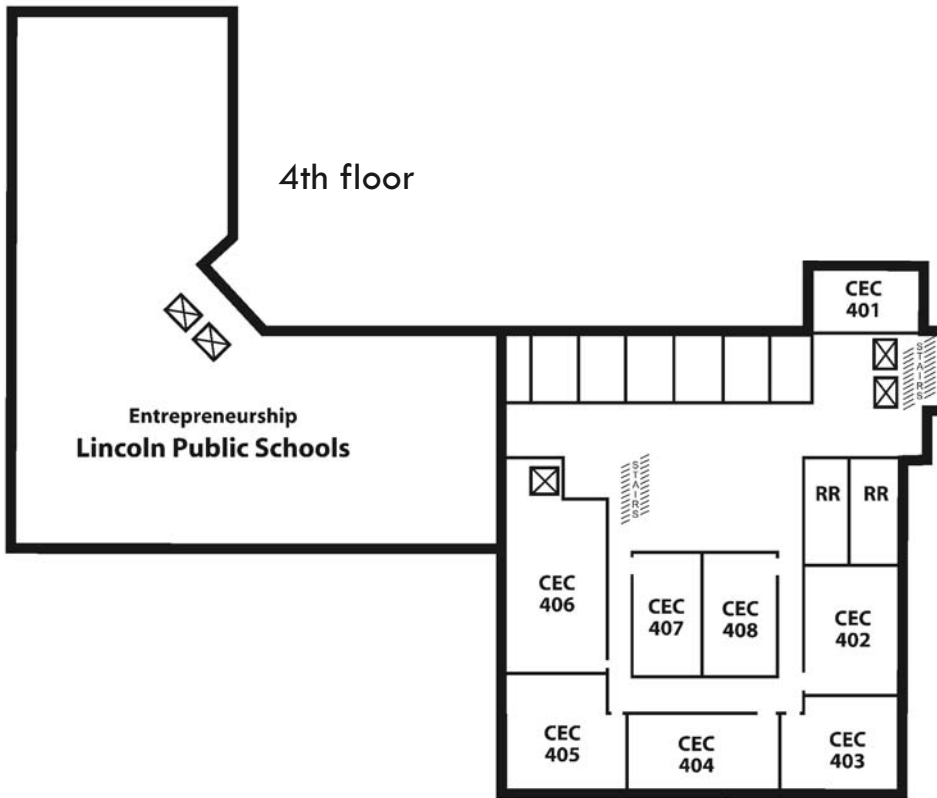

ENT 4th floor:

Offices for Lincoln Public Schools Entrepreneurship and Information Technology focus programs

Access between CEC and ENTR buildings is not allowed through alarmed doors.

CEC 4th floor: Continuing Education Offices for: Dean, Director of Personal Enrichment and Leisure, Director of Health, Director of Transportation & Safety, eLearning Marketing Specialist, Publications Specialist

Classrooms for: Continuing Education
Computer Labs

ENT 5th floor:

Offices for Business Resources

- Community Development Resources
- Nebraska Business Development Center Procurement Division
- SCORE (Service Corps of Retired Executives)
- Junior Achievement
- WasteCap Nebraska

Access between CEC and ENTR buildings is not allowed through alarmed doors.

CEC 5th floor: SCC-Area Office

Offices for College Administration including:

- Administrative Services
- Access/Equity/Diversity
- Educational Foundation
- Human Resources
- Instructional Administration
- K-12/Career Academies Administration
- President
- Public Information/Marketing

